



Stoneacre
Properties



Eyres Mill Side, Leeds, LS12 3DE
£750 Per Calendar Month

Stoneacre Properties are delighted to offer to let a ground floor, double bedroom apartment located in the new build, sought after development of 'Mill Pond Gardens', part of the Winker Green development in Armley.

The property boasts a fresh interior and comes complete with fridge freezer, washing machine and dryer. This property really is a must view! Unfurnished and Available NOW!

Please call our office to register your details and book your viewing today!

Floor Plan

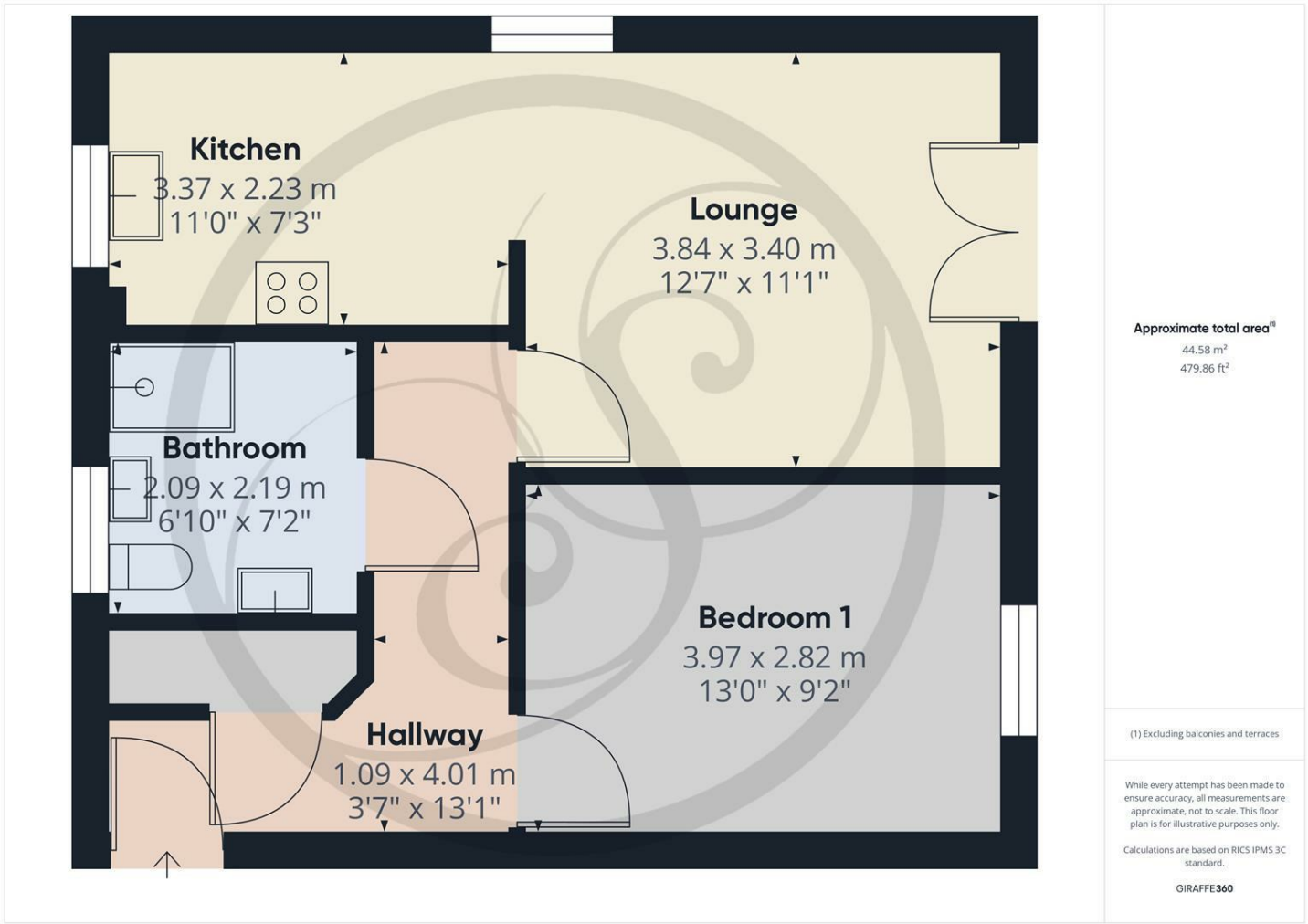

Area Map

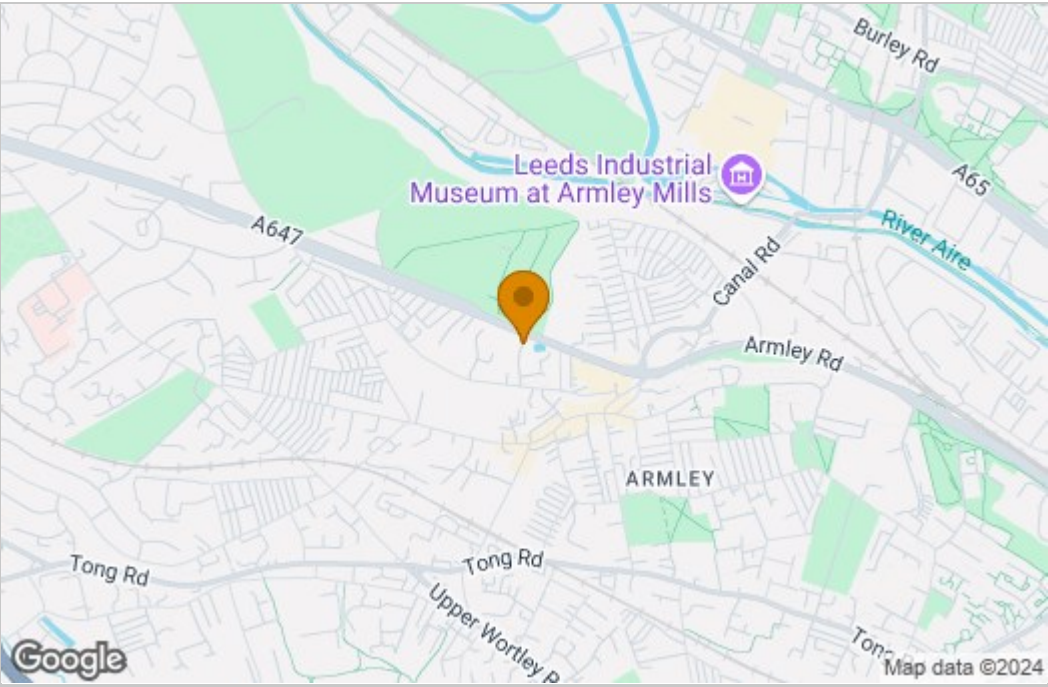

Energy Efficiency Graph

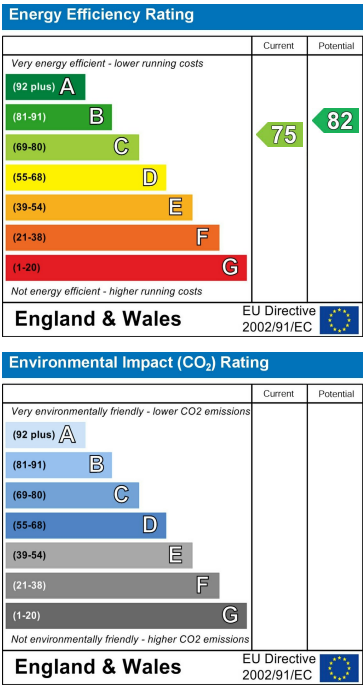

These particulars, whilst believed to be accurate are set out as a general outline only for guidance and do not constitute any part of an offer or contract. Intending purchasers should not rely on them as statements of representation of fact, but must satisfy themselves by inspection or otherwise as to their accuracy. No person in this firm's employment has the authority to make or give any representation or warranty in respect of the property.

